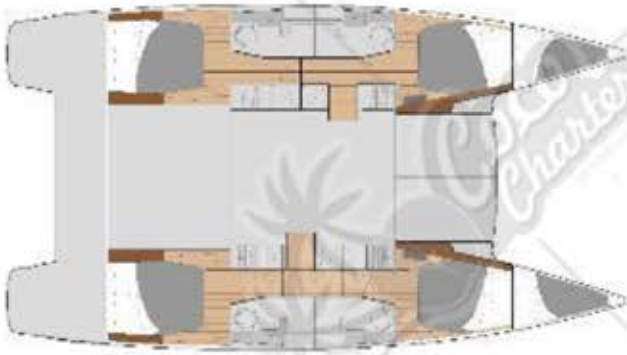

# Sailing catamaran Helia 44 Evolution

BASIC INFORMATION	LAYOUT
<ul style="list-style-type: none"> <li>▪ Year: 2018</li> <li>▪ Builder: Fountaine Pajot</li> <li>▪ Length: 13.3 m</li> <li>▪ Beam: 7.4 m</li> <li>▪ Draft: 1.15 m</li> <li>▪ Displacement: 10,800 kg</li> <li>▪ Engines: 2 x Volvo 55 HP D2</li> <li>▪ Fuel tank: 470 L</li> <li>▪ Water tank: 2 x 375 L (total 750 L)</li> <li>▪ Double cabins: 4</li> <li>▪ Single cabins: 2</li> <li>▪ Bed in saloon: convertible table</li> <li>▪ Persons [recomm./licensed]: 8/10</li> <li>▪ Showers [cabins + deck]: 4 + 1</li> <li>▪ Heads [cabins]: 4</li> </ul>	
SALOON	GALLEY
<ul style="list-style-type: none"> <li>▪ Interior Layout: <ul style="list-style-type: none"> <li>- Woodwork With Alpi</li> <li>- Saloon / cabin flooring : parquet</li> <li>- Lining on rot proof glass felt</li> <li>- Sofa cushions leather style</li> <li>- Polyeter foam mattresses</li> </ul> </li> <li>▪ Saloon: <ul style="list-style-type: none"> <li>- <b>Full air conditioning 220V 50HZ main syst. 48K BTU</b></li> <li>- <b>Combination lock safe</b></li> <li>- <b>Salon table convertible into berth</b></li> <li>- <b>12V fan x 2</b></li> <li>- Saloon access through a sliding Altuglas door – 1 with entrance carpet</li> <li>- Panoramic view through picture windows and aft-facing porthole</li> <li>- Natural lighting by 2 roof bay</li> <li>- 1 wooden table</li> <li>- 6 places bench seat</li> <li>- Large cupboards under bench</li> <li>- Ventilation via 2 large front-opening hatches</li> <li>- Principal lighting by spot LED</li> </ul> </li> </ul>	<ul style="list-style-type: none"> <li>▪ <b>12V 90L Freezer</b></li> <li>▪ <b>Galley fully equipped</b></li> <li>▪ Open kitchen to the outside by sliding bay</li> <li>▪ Sink work top in synthetic resin</li> <li>▪ 2 stainless steel sinks</li> <li>▪ Pressurized hot and cold freshwater from mixer faucet</li> <li>▪ 1 draining board</li> <li>▪ 1 top accessed trash can, bags removed through separate door</li> <li>▪ 1 x 3 burner stove with pan holder</li> <li>▪ 1 stainless gaz oven</li> <li>▪ 1 cutlery drawer</li> <li>▪ 190L cold storage volume (fridge)</li> <li>▪ 1 large cupboard in starboard side of the entry door</li> <li>▪ LED spotlighting</li> <li>▪ Ventilation by 1 opening hatch above stove top</li> </ul>
CHART TABLE	FOREPEAKS
<ul style="list-style-type: none"> <li>▪ Wooden chart table and storage with flap</li> <li>▪ High navigation instruments console</li> <li>▪ Electric panel 12V</li> <li>▪ One 12V electric outlet</li> <li>▪ Chart table lighting by reading light</li> </ul>	<ul style="list-style-type: none"> <li>▪ <b>2x Forepeak deck hatch</b></li> <li>▪ <b>Complete fitting out port forepeak</b></li> <li>▪ <b>Complete fitting out stb forepeak</b></li> <li>▪ Access via a wooden door in for cabin</li> <li>▪ Fully-painted, gel-coat finish</li> <li>▪ Buoyancy reserve under half-height shelf</li> </ul>
CABINS x 4 (QUATUOR VERSION)	HEADS COMPARTMENTS x 4 (QUATUOR VERSION)
<ul style="list-style-type: none"> <li>▪ <b>Curtains in cabins</b></li> <li>▪ <b>12V fan (total x4)</b></li> <li>▪ <b>Full air conditioning 220V 50HZ main syst. 48K BTU</b></li> <li>▪ Aft Cabin: <ul style="list-style-type: none"> <li>- Access through wooden door in passageway</li> <li>- Double bed (1,60x2,00 m) with lateral access s (island bed)</li> <li>- 1 Drawer under bed with frontal access s</li> <li>- Shelving on side of bed</li> <li>- 1 hanging closet</li> </ul> </li> </ul>	<ul style="list-style-type: none"> <li>▪ <b>Large electric marine toilet (total 4)</b></li> <li>▪ Access through wooden door</li> <li>▪ Worktop with sink</li> <li>▪ Mirror + shelves + spotlights</li> <li>▪ Hot and cold water by mixer</li> <li>▪ Separate shower with mixer tap with built-in showerhead</li> <li>▪ Shower with electrical drainage pump</li> <li>▪ Cupboard storage with internal shelves under worktop</li> <li>▪ Coat hook</li> <li>▪ Ventilation through 1 deck hatch</li> </ul>

# Sailing catamaran Helia 44 Evolution

- 1 Console with shelves inside
- Ventilation through 1 deck hatch + via 1 porthole overlooking rear deck
- Aft and rear panoramic bay
- Large non-opening outward-facing picture window
- Curtains on all openings
- Main lighting via spotlights LED and 2 bedside reading lights
- Coat hook
- Cupboards storage under bed
- Fore cabin:
  - Access through wooden door in passageway
  - **Double bed with lateral access (island bed): stb 1,60/1,3 x 2m, port 1,60/1,10 x 2m**
  - 1 Drawer under bed with frontal access
  - 1 hanging closet
  - 1 console with internal shelves
  - 1 shelf above bed
  - Ventilation through 1 deck hatch and 1 hull hatch
  - 1 escape hatch opening
  - Large non-opening outward-facing picture window
  - Curtains on all openings
  - Main lighting via spotlights LED and 2 bedside reading lights
  - Coat hook
  - Cupboards storage under bed
- Cupboards in passageways

## DECK LAYOUT

- Cockpit entirely protected by a rigid bimini. Circulation without step towards the saloon.
- Cockpit:
  - **Hard bimini top over the cockpit**
  - **Manual gangway**
  - **Exterior window blinds for salon**
  - **Gas barbecue**
  - **Cockpit fridge**
  - **Cockpit courtesy lighting**
  - 1x 8 persons bench seat around the table
  - 1 Teck cockpit table
  - Serving hatch to the kitchen by sliding bay
  - 1 Fainting sofa
  - 1 Large storage area on the bench
  - 1 Large storage area on the fainting sofa
  - 1 Gas chest for 2 bottles
  - Natural lighting and ventilation via deck hatches
  - Lighting by waterproof spotlights
- Helm station:
  - **Triple helmsman seat with back rest**
  - **Electric winch for mainsail**
  - **Bimini for helm station**
  - **Tent for bimini helm station**
  - Accessed via stairs from cockpit
  - Instrument control panel
  - Bin for halyards
  - Stairs to access of lounge deck

## FITTINGS

- G.V. and genoa:
  - 1 mainsheet tackle led aft to coach roof
  - 1 clutch for mainsail sheet
  - 1 clutch for mainsail halyard
  - 3 clutch for the reef
  - 1 Ball bearing mainsheet traveller
  - 2 x tackle on mainsheet traveller clutches with back on roof
  - 2 x genoa tracks with load block
  - 2 x genoa sheets
  - 2 x -size 50 self tailing winches for genoa and mainsail sheets
  - 1 size 46 self tailing winch for main sheet
- Other equipment:
  - **Solar panels 4x90/100 W**
  - **2 swim ladder**
  - **Pulpits with 2 seating**
  - **1 hot & cold water shower in port transom**
  - **Dralon protective cover for wheel**
  - **Teak floor transoms/cockpit**
  - **Outdoor cushions**
  - **Outdoor foredeck cushions**
  - **Both transoms protection**
  - **Chain + 25KG Anchor**
  - **PVC Dinghy 3.4m & 9.9 HP engine**
  - **Full navigational, safety and technical equipment**
  - **Leather covered steering wheel helm**

# Sailing catamaran Helia 44 Evolution

<ul style="list-style-type: none"> <li>▪ Lounge deck:               <ul style="list-style-type: none"> <li>- Access via stairs through helm station</li> <li>- Area available for solarium and mattresses.</li> </ul> </li> <li>▪ Fore deck:               <ul style="list-style-type: none"> <li>- 1 Large chest for anchorage and halyard tail storage at bottom of mast</li> </ul> </li> <li>▪ 2 Engine holds:               <ul style="list-style-type: none"> <li>- Accessed via polyester deck hatch in cockpit</li> <li>- Sound proofing</li> <li>- Neon lighting</li> </ul> </li> </ul>	<ul style="list-style-type: none"> <li>- 2 rudders linked mechanically by stock arm + transversal tube</li> <li>- Emergency tiller</li> <li>- 1 steering compass</li> <li>- 3 winch handles and 3 pockets</li> <li>- Pulpit and pushpit, stanchions with upper and lower guardrails</li> <li>- Access to transom</li> <li>- 2 x tender davit kayak carrier with 1 x winch 40</li> <li>- 7 mooring cleats (2 foredeck + 2 middle + 2 astern + 1 in anchor well)</li> <li>- Mooring kit + 6 fenders</li> <li>- 2 x 50 ft long mooring lines</li> <li>- <b>1 x 1500W electric windlass with circuit breaker protection</b></li> <li>- Anchor fairlead under bridge deck with built-in bridle</li> <li>- 1 roller on forward beam</li> <li>- Net on forward beam</li> <li>- 1 kit of spare parts</li> </ul>
<p><b>MOTORIZATION</b></p> <ul style="list-style-type: none"> <li>▪ Engines and Equipments:               <ul style="list-style-type: none"> <li>- <b>2 motors 55 HP (instead of 40 HP)</b></li> <li>- 2x2 blade fixed propellers</li> <li>- Salt water filter</li> <li>- Engine cooling by heat exchanger</li> <li>- Complete engine panel and dual controls at helm station</li> <li>- Hour meter</li> </ul> </li> <li>▪ Fuel system:               <ul style="list-style-type: none"> <li>- 1 Fuel tank with filling by plug-hole on bridge equipped with a anti-overflow</li> <li>- Electric fuel gauge (indicator on chart table)</li> <li>- 1 fuel pre-filter / water separator +1 engine fuel filter/engine</li> <li>- Fuel shutoff valves</li> </ul> </li> <li>▪ Other:               <ul style="list-style-type: none"> <li>- Triple clutche for reefs</li> </ul> </li> </ul>	<p><b>PLUMBING</b></p> <ul style="list-style-type: none"> <li>▪ Deck shower – hot &amp; cold</li> <li>▪ Auto. switch for bilge pumps</li> <li>▪ Pressurized seawater system</li> <li>▪ Additional electric freshwater pump</li> <li>▪ Freshwater tanks with electric gauge</li> <li>▪ 1 electric pump and pressure accumulator</li> <li>▪ 1 water heater 40 l</li> <li>▪ 1 electrical bilge pump (2 m3/h) in each engine hold</li> <li>▪ 1 electric bilge pump (2m3/h) in each hull</li> <li>▪ 1 manual exterior bilge pump</li> <li>▪ 1 holding tank on each W.C.</li> <li>▪</li> </ul>
<p><b>ELECTRICITY / ELECTRONIC</b></p> <ul style="list-style-type: none"> <li>▪ Power system:               <ul style="list-style-type: none"> <li>- <b>Additional AGM battery 150A suppl.</b></li> <li>- 2 x 115A/12V engine alternators</li> <li>- 1 set starboard onboard/engine batteries of 600A/h</li> <li>- 1 port engine battery of 100A/h/ 800CCA</li> <li>- 1 Manual back-up link</li> </ul> </li> <li>▪ 12V electrical distribution panel:               <ul style="list-style-type: none"> <li>- <b>Interior 12V outlet and waterproof exterior 12V outlet</b></li> <li>- General 12V distribution panel at chart table protected by circuit breakers</li> <li>- Voltmeter for onboard batteries</li> <li>- Spare sockets for extra equipment</li> </ul> </li> <li>▪ Other:               <ul style="list-style-type: none"> <li>- <b>Full air conditioning 220V 50HZ main syst.48K BTU</b></li> <li>- <b>Watermaker 180L/h 50HZ</b></li> <li>- <b>Solar panels 4x90/100 W</b></li> <li>- <b>9KW 220V 50HZ genset</b></li> <li>- <b>1 x 1500W electric windlass with circuit breaker protection</b></li> </ul> </li> </ul>	<p><b>RIGGING &amp; SAILS</b></p> <ul style="list-style-type: none"> <li>▪ Mast and boom:               <ul style="list-style-type: none"> <li>- <b>Lazy jack and lazy bag</b></li> <li>- <b>Electric winch for mainsail</b></li> <li>- <b>Automatic reef on the first reef</b></li> <li>- <b>Add. windlass control chain counter</b></li> <li>- Mast and boom in anodised aluminium</li> <li>- Complete standing rigging</li> <li>- Ball bearing mainsail luff cars</li> <li>- 1 tackle on mainsail halyard</li> <li>- 1 topping lift</li> <li>- 3 reef pennants</li> <li>- 1 genoa halyard</li> <li>- 1 spinnaker halyard</li> <li>- clutches on all halyards for genoa, spinnaker and topping lift</li> <li>- clutches on reef pennants at boom exit</li> <li>- 2 flag halyards</li> <li>- Navigation, running and mooring lights</li> <li>- Deck lighting</li> </ul> </li> </ul>

# Sailing catamaran Helia 44 Evolution

- |                                                                                                                                                                                                                                                                                                                                                                                                                                                                                                                                                                                                                                                                                                                                                                                                   |                                                                                                                                                                                                  |
|---------------------------------------------------------------------------------------------------------------------------------------------------------------------------------------------------------------------------------------------------------------------------------------------------------------------------------------------------------------------------------------------------------------------------------------------------------------------------------------------------------------------------------------------------------------------------------------------------------------------------------------------------------------------------------------------------------------------------------------------------------------------------------------------------|--------------------------------------------------------------------------------------------------------------------------------------------------------------------------------------------------|
| <ul style="list-style-type: none"><li>- Electric winch for mainsail</li><li>- Fusion audio pack Bluetooth 4 Sp</li><li>- 220V main system with charger 60A</li><li>- 2000W Inverter/charger / 220V 50hz</li><li>- Second VHF AIS helmstation</li><li>- GARMIN Pack 2 : Autopil, VHF, AIS, 2*GPS 7410, 2*multi GMI20</li><li>- Radar + support + wiring</li><li>- GARMIN autopilot remote</li><li>- TV screen (22") multimedia 16/9 with DVD player units for 1 cabin</li><li>- Electric head large bowl (total 4)</li><li>- 12V fan (total 6)</li><li>- Additional electric freshwater pump</li><li>- Automatic mainsail HOOK</li><li>- Automatic reef on the first reef</li><li>- Add. windlass control chain counter</li><li>- Electric davit winch</li><li>- 1 VHF mast head antenna</li></ul> | <ul style="list-style-type: none"><li>▪ Sails:<ul style="list-style-type: none"><li>- Full batten CST mainsail</li><li>- Genoa roller fuller</li><li>- Genoa with no UV band</li></ul></li></ul> |
|---------------------------------------------------------------------------------------------------------------------------------------------------------------------------------------------------------------------------------------------------------------------------------------------------------------------------------------------------------------------------------------------------------------------------------------------------------------------------------------------------------------------------------------------------------------------------------------------------------------------------------------------------------------------------------------------------------------------------------------------------------------------------------------------------|--------------------------------------------------------------------------------------------------------------------------------------------------------------------------------------------------|

# Sailing catamaran Helia 44 Evolution

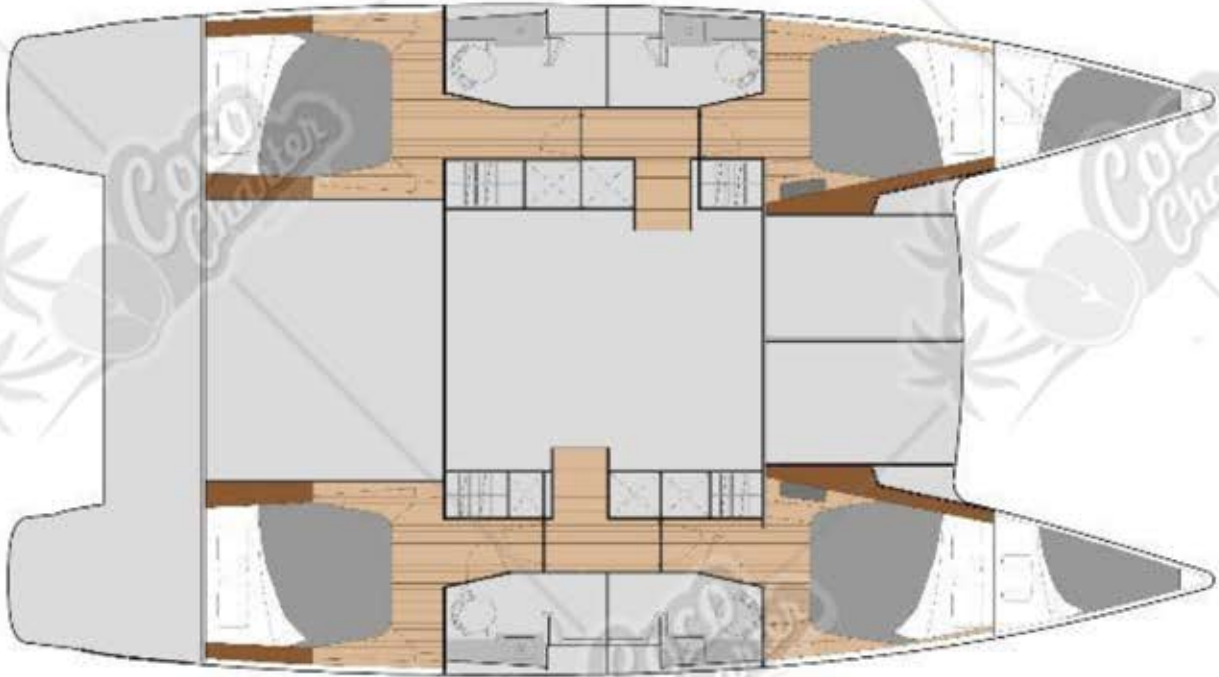

*Sailing calamarian  
Helia 44 Evolution*

