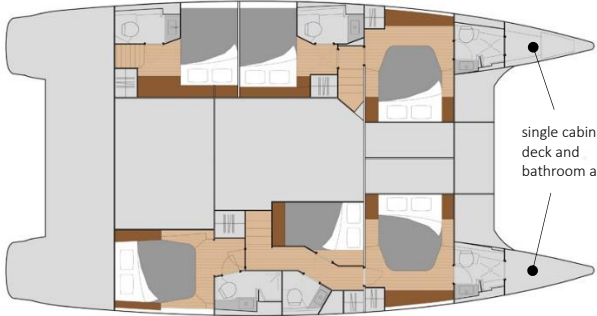

Sailing catamaran

Saba 50 Grand Large

BASIC INFORMATIONS	LAYOUT
<ul style="list-style-type: none"> ▪ Year: 2018 ▪ Builder: Fountaine Pajot ▪ Length: 14.98 m ▪ Beam: 7.99 m ▪ Draft: 1.25 m ▪ Displacement: 15,700 kg ▪ Engines: 2 x 75 HP ▪ Fuel tank: 2 x 470 L (total 940 L) ▪ Water tank: 700 L ▪ Double cabins: 6 ▪ Single cabins: 2 ▪ Bed in saloon: no ▪ Persons [recomm./licensed]: 12 / 14 ▪ Showers [cabins + deck]: 7 ▪ Heads [cabins]: 6 	
HIGHLIGHTS	HIGHLIGHTS - continued
<ul style="list-style-type: none"> ▪ Air conditioning 220V 50HZ main syst. 68K BTU ▪ Watermaker 300L/h ▪ 11KW 220V 50HZ genset ▪ 2000W Inverter/charger / 220V 50hz ▪ 220V main system with charger ▪ Electric head large bowl (total 5) ▪ Solar panels 4X90/100 W ▪ Electric winch for genoa sheet ▪ Hydraulic aluminium davits + Supp cradle ▪ 1500W electric windlass with circuit breaker protection ▪ 12V fan in cabins (total 6) ▪ Eco Cruising Monitor ▪ Underwater lighting 2x21 W 	<ul style="list-style-type: none"> ▪ Galley fully equipped (coffee machine, blender, ice-maker, dishes, pots, glasses, etc.) ▪ Complete fitting out stb forepeak ▪ TV screen (22") multimedia 16/9 with DVD player unit for 1 cabin ▪ Lounge deck: area with mattresses ▪ Teak floor transoms/cockpit ▪ Gas barbecue ▪ Hot and cold shower in the port platform ▪ Teak cockpit table extension for 12 persons ▪ Cockpit fridge (75L) with build in small freezer ▪ Dinghy 3.8m with 15HP engine ▪ Outdoor cushions (cockpit + lounge deck)
SALOON	CHART TABLE
<ul style="list-style-type: none"> ▪ Exterior window blinds for saloon ▪ Diner table/coffee table in saloon ▪ Salon flooring : Timber-laid floor ▪ Seat cushions ▪ Accessible via a single-leaf sliding door with carpeted entrance ▪ Panoramic vie through picture windows ▪ Natural lighting via 2 glass panels ▪ 6 places bench seat ▪ Large storage boxes under the bench ▪ Ventilation via to 2 large front opening hatches ▪ Main lighting system by 5 spotlights 	<ul style="list-style-type: none"> ▪ 2x Interior 12V outlet ▪ Wooden chart table and storage with flap cover ▪ High navigation instrument console ▪ 12V Electric panel ▪ Lighting via 1 spotlight & 1 reading lamp for the chart table
GALLEY	FOREPEAK
<ul style="list-style-type: none"> ▪ 12V 90L Freezer ▪ 220V Microwaves oven ▪ Galley fully equipped (coffee machine, blender, ice-maker, dishes, pots, glasses, etc.) ▪ Dishwasher ▪ Galley opened to the outside thanks to a sliding bay ▪ Ventilation via 1 opening hatch above stove top ▪ Worktop ▪ Twin stainless-steel sinks ▪ 1x top accessed trash can, bags removed through separate door ▪ Pressurized hot and cold freshwater system from mixer faucet ▪ 1x 4 burner stove with pan holder ▪ 1x stainless gas oven ▪ Front closet that can accommodate a maximum volume of 130L/34gals in refrigeration mode or 90L/24gals in conservation mode ▪ 1x cutlery drawer, 2 drawer for pots & pans ▪ 190L cold storage volume (12V) in central "island" cabinet ▪ 1x large storage cupboard on the starboard side of the entrance ▪ 3x storage spaces underneath the floor ▪ 4x spotlights 	<ul style="list-style-type: none"> ▪ Fore peak (starboard): <ul style="list-style-type: none"> - Complete fitting out stb forepeak - Access from the forward bathroom or the deck hatch - Fully-painted, gel-coat finish - Buoyancy reserve under half-height shelf Lining covered ceilings ▪ Forepeak (port hull): <ul style="list-style-type: none"> - Storage space only - Access from the forward bathroom - Fully-painted, gel-coat finish - Buoyancy reserve under half-height shelf
CABINS x 6 (QUINTET VERSION)	CABINS x 6 (QUINTET VERSION) - continued
<ul style="list-style-type: none"> ▪ TV screen (22") multimedia 16/9 with DVD player unit for 1 cabin ▪ 12V fan in cabins (total 6) ▪ Curtains in cabins 	<ul style="list-style-type: none"> ▪ Port hull - a companionway behind the saloon gives access to the starboard hull. The amidships & fore cabins though a companionway ahead of the saloon:

Sailing catamaran Saba 50 Grand Large

<ul style="list-style-type: none"> ▪ Cabins flooring : Timber-laid floor ▪ Polyether foam mattresses ▪ Starboard hull - a companionway behind the saloon gives access to the starboard hull: <ul style="list-style-type: none"> - Wooden staircase on stainless steel silt - Lighting via 2 spotlights ▪ Aft Cabin (starboard hull): <ul style="list-style-type: none"> - Access from the companionway via a wooden door - Queen-size Island Bed (1,60 x 2m) - Drawer below the bed with frontal access - Bedside shelves - Wardrobe - Cupboard with shelves in it - Ventilation via a deck hatch + 1 porthole overlooking the rear deck - Rear panoramic window - Large picture-window on hull side - Curtains to all windows - Main lighting via 2 spotlights & 2 berth lights - 1 Bedside two-way switch - Clothes hooks - Lining covered ceilings ▪ Crew cabin (starboard hull): <ul style="list-style-type: none"> - Access from the companionway via a wooden door - Double bed (1.30m x 2m) - Hanging closet in the companionway - Storage room below the bed - Lighting via 2 spotlights + berth light - Controlled Mechanical Ventilation in the cabin ▪ Fore cabin (starboard hull): <ul style="list-style-type: none"> - Access from the companionway via a wooden door - Queen-size Island Bed/ Double bed (1.60 x 2m) - Drawer below the bed with frontal access - Wardrobe - Cupboard with shelves in it - Ventilation thanks to a deck hatch + 1 porthole - Large picture-window on hull side - Curtains to all windows and doors - Main lighting via 2 spotlights & 2 berth lights - 1 Bedside two-way switch - Clothes hooks - Lining covered ceilings 	<ul style="list-style-type: none"> - Wooden staircase with stainless steel silt - 1 spotlight ▪ Aft cabin (port hull): <ul style="list-style-type: none"> - Access from the cockpit though Plexiglas door including keylock - Queen-size bed (1.60 x 2m) - Drawer below the bed with frontal access - Wardrobe - Cupboard with shelves in it - Ventilation thanks to a deck hatch - Large picture-window on hull side - Curtains to all windows and doors - Lining covered ceilings - Main lighting via 2 spotlights & 2 berth lights - 1 Bedside two-way switch - Clothes hook - Lining covered ceilings ▪ Central cabin (port hull): <ul style="list-style-type: none"> - Access from the companionway via a wooden door - Queen-size bed (1.60 x 2m) - Drawer below the bed with frontal access - Wardrobe - Ventilation thanks to a deck hatch & 1 porthole - Large picture-window on hull side - Curtains to all windows and doors - Main lighting via 2 spotlights & 2 berth lights - 1 Bedside two-way switch - Clothes hook - Lining covered ceilings
DECK LAYOUT	DECK LAYOUT - continued
<ul style="list-style-type: none"> ▪ Helm station: <ul style="list-style-type: none"> - Bimini for helm station - Enclosure for bimini helm station - Access through staircase from the cockpit - Enclosure for bimini helm station - Triple helmsman seat - Instrument console - 360° view / All-round visibility - Access to the Lounge deck through staircase ▪ Lounge deck: <ul style="list-style-type: none"> - Area with mattresses - Access via staircase from wheelhouse - Surface: 13 m² - Visibility 360° - Lounge with large sofa - Fainting sofa at port - Stowag - e locker at port ▪ Fore-deck saloon: <ul style="list-style-type: none"> - Grand coffre avant, access to anchorage and fresh water tanks - 1 Large chest giving access to windlass and anchor as well as water tanks - Relaxation area with U-shaped sunbed ▪ Engine holds: 	<ul style="list-style-type: none"> ▪ Cockpit: <ul style="list-style-type: none"> - 2x swimming ladders - Teak floor transoms/cockpit - Gas barbecue - Hot and cold shower in the port platform - Teak cockpit table extension for 12 persons - Cockpit fridge - Dinghy 3.8m with 15HP engine - Hydraulic aluminium davits + Supp cradle - Waterproof exterior 12V outlet - Cockpit courtesy lighting - Large cockpit: 19m², Circulation without threshold towards the saloon - Access via the transom platforms - Transom platform with swimming ladder (at port) & handrail - GRP Bimini protecting all the cockpit - 8 seats sofa around the table - Serving hatch to the galley via sliding bay - 1x Large storage area under the sofa - 1x fainting sofa with large storage locker - 1x Transom sofa with large storage locker - 2x Sunbeds - 1x Gas chest for 2 bottles - Space for the liferaft under the stairs leading to helm station

Sailing catamaran Saba 50 Grand Large

<ul style="list-style-type: none"> - Access via polyester deck hatch installed on stainless steel gas cylinders - Sound proofing - Neon lighting 	<ul style="list-style-type: none"> - Additionnal ventilation and lighting via 1 deck hatch - Lighting via 2 waterproof spotlights
MOTORIZATION	PLUMBING
<ul style="list-style-type: none"> ▪ Engines & Equipments: <ul style="list-style-type: none"> - 2x Saildrive Volvo engine D2 75 HP - 3x Blades fixed propeller - Sea water strainers - Engine cooled via heat exchanger - Complete engine panel and dual controls levers at helm station - Hour meter ▪ Fuel System: <ul style="list-style-type: none"> - 1x Fuel tank 470L in each hull (two in total) - fuel filling on both side decks including backflow protection device - 2x Electric fuel gauge (indicator at chart table) - 1x Fuel pre-filter / water separator + 1 engine fuel filter / engine - Fuel shut-off valves 	<ul style="list-style-type: none"> ▪ Freshwater: <ul style="list-style-type: none"> - Additional electric freshwater pump - Water Maker – Aqua Base – 300l/h – 230V/50Hz - auto Pressurized seawater system - 2 Freshwater tanks in the technical compartment at bow (700L total capacity) - 1 Electric gauge at chart table - 1 Electric pump and pressure accumulator - 1 Mixed water heater 60l in port hull - Available space for an additional water heater in the starboard hull ▪ Grey water: <ul style="list-style-type: none"> - Shower drainage via individual shower pump (automatic pump-out). ▪ Bilging system : <ul style="list-style-type: none"> - 1 electric bilge pump (2m³/h – 4163l/h) in each engine room - 1 electric bilge pump (2m³/h – 4163l/h) in each hull - 1 manual exterior bilge pump ▪ Deck shower: <ul style="list-style-type: none"> - Hot water deck shower
HEADS COMPARTMENTS x 6 (QUINTET VERSION)	HEADS COMPARTMENTS x 6 (QUINTET VERSION) - continued
<ul style="list-style-type: none"> ▪ Fore & aft bathrooms (starboard hull): <ul style="list-style-type: none"> - Electric head large bowl (total 5) - Access via wooden door - Washbasin with worktop - Mirror with shelf - Hot and cold freshwater system from mixer faucet - Shower separated via a Plexiglas panel - Electric drainage pump - Mixing valve tap for shower - Storage closet with shelves under the worktop - Clothes hooks - Ventilation via 1 deck hatch - Lighting via 2 spotlights ▪ Crew bathroom (starboard hull): <ul style="list-style-type: none"> - Electric head large bowl (total 5) - Access from the companionway via a wooden door - Worktop & washbasin with mixer faucet - Mirror - Shower with electric drainage pump - Clothes hooks - Ventilation thanks to 1 deck hatch - 1 spotlight 	<ul style="list-style-type: none"> ▪ Aft, central and fore bathroom (port hull): <ul style="list-style-type: none"> - Electric head large bowl (total 5) - Access via wooden door - Washbasin with worktop - Mirror with shelf - Hot and cold freshwater system from mixer faucet - Shower separated via a Plexiglas panel - Electric drainage pump for greywater - Mixing valve tap for shower - Storage closet with shelves under the worktop - Clothes hooks - Ventilation thanks to 1 deck hatch - Lighting via 2 spotlights
ELECTRICITY / ELECTRONIC	ELECTRICITY / ELECTRONIC - continued
<ul style="list-style-type: none"> ▪ Electronic: <ul style="list-style-type: none"> - Second VHF AIS helmstation - GARMIN Pack 3: Autopilot, VHF, AIS, GPS 7412/7410, 2*multi GMI20 - Radar + support + wiring - GARMIN autopilot remote - TV screen (22") multimedia 16/9 with DVD player unit for 1 cabin. - Eco Cruising Monitor - VHF mast head antenna prewired - Fusion audio pack Bluetooth 4 Sp. - Video TV/HIFI pack - TV/radio antenna ▪ Other: <ul style="list-style-type: none"> - Air conditioning 220V 50HZ main syst. 68K BTU - 12V fan in cabins (total 6) - Solar panels 4X90/100 W - Additional electric freshwater pump - Underwater lighting 2x21 W - Add. windlass control chain counter 	<ul style="list-style-type: none"> ▪ Power circuit: <ul style="list-style-type: none"> - Additional AGM battery 150A suppl. - 220V main system with charger - 2000W Inverter/charger / 220V 50hz - 11KW 220V 50HZ genset - 2 x 115A/12V engine alternators - 1 set starboard onboard/engine batteries of 600A/h (4 x 150 Ah) - 1 port engine battery of 50A/h/ 800CCA - 1 automatic back-up link and 1 Manual back-up link ▪ 12V Electrical Distribution Panel: <ul style="list-style-type: none"> - Interior 12V outlet x2 - General 12V distribution panel at chart table protected via circuit breakers - Voltmeter for onboard batteries - Spare sockets for extra equipment - All accomodation lightings LED - All LED lighting functions monitored by multiplexing system

Sailing catamaran Saba 50 Grand Large

<ul style="list-style-type: none"> - Hydraulic aluminium davits + Supp cradle - Watermaker 110L/h 50HZ Ecotech 	
DECK FITTINGS	DECK FITTINGS - contunued
<ul style="list-style-type: none"> ▪ Helm station: <ul style="list-style-type: none"> - Electric winch for genoa sheet - 1 mainsheet tackle led aft to coach roof - 1 clutch for mainsail sheet - Size 60 self tailing winches for mainsail - 1 Ball bearing mainsheet traveler - 2 x tackle on mainsheet traveler clutches with back on roof - 2 x genoa tracks with load block - 2 genoa sheets - 1 size 50 self tailing winchs for main halyard and reef lines - 1 halyard storage bag ▪ Bar system: <ul style="list-style-type: none"> - 2 foam sandwich rudders on stainless steel rudder stock - Hydraulic steering system with manual pump and 1 cylinder (starboard side) - Rudders linked mechanically by stock arm + transversal tube - Aluminium sterntubes - Self lining upper and lower rudderstock bearings - Emergency tiller 	<ul style="list-style-type: none"> ▪ Other Equipments: <ul style="list-style-type: none"> - Teak floor transoms/cockpit - Cockpit fridge - Cockpit ice maker 50HZ - Solar panels 4X90/100 W - 1500W electric windlass with circuit breaker protection - Add. windlass control chain counter - Hydraulic aluminium davits + Supp cradle - Pulpits with 2 bow pulpit seats - Outdoor cushions (cockpit + lounge deck) - Outdoor foredeck cushions - Seat cushions - 1 steering compass - 3 winch handles with their 3 pockets - Pulpit and pushpit, stanchions with upper and lower guardrails - Access to transom - 2 x tender davits with 1 x size 46 winch on port side - 7 mooring cleats (2 foredeck + 2 middle + 2 astern + 1 in anchor well) - Protection for both transom - 6 fenders - 2 x 50 ft long mooring lines - Anchor fairlead under bridge deck with built-in bridle - 1 roller on forward beam - Net on forward beam - 1 kit of spare parts
RIGGING & SAILS	GENERAL EQUIPMENT / OTHER
<ul style="list-style-type: none"> ▪ Mast & Boom: <ul style="list-style-type: none"> - Lazy jack and lazy bag - Mast and boom in anodized aluminum - Complete standing rigging - Ball bearing mainsail luff cars - 1 tackle on mainsail halyard - 1 topping lift - 3 reef pennants - 1 genoa halyard - 1 spinnaker halyard - Spinlock/Antal Clutches on all halyards for genoa, spinnaker and topping lift - Spinlock/Antal Clutches on reef pennants at boom exit - 2 flag halyards - Navigation, running and mooring lights - Deck lighting ▪ Sails: <ul style="list-style-type: none"> - Electric winch for genoa sheet - CST mainsail full batten - Full batten CSR mainsail - Roller genoa furler - Genoa with UV band 	<ul style="list-style-type: none"> ▪ Combination lock safe ▪ Mooring kit + 6 fenders ▪ Double clutche for reefs 2 and 3 ▪ Auto. switch for bilge pumps ▪ Dralon protective cover for wheel ▪ Upgrade Bose ▪ Protective strip on both transoms ▪ Synthetic teak floor transoms and cockpit ▪ 60m chain + 25kg anchor ▪ Antifouling, primary epoxy ▪ Safety equipment ▪ MP12 container life raft ▪ Alpi woodworking ▪ Lining on rotproof glass felt ▪ Polyether foam mattresses

Sailing catamaran Saba 50 Grand Large

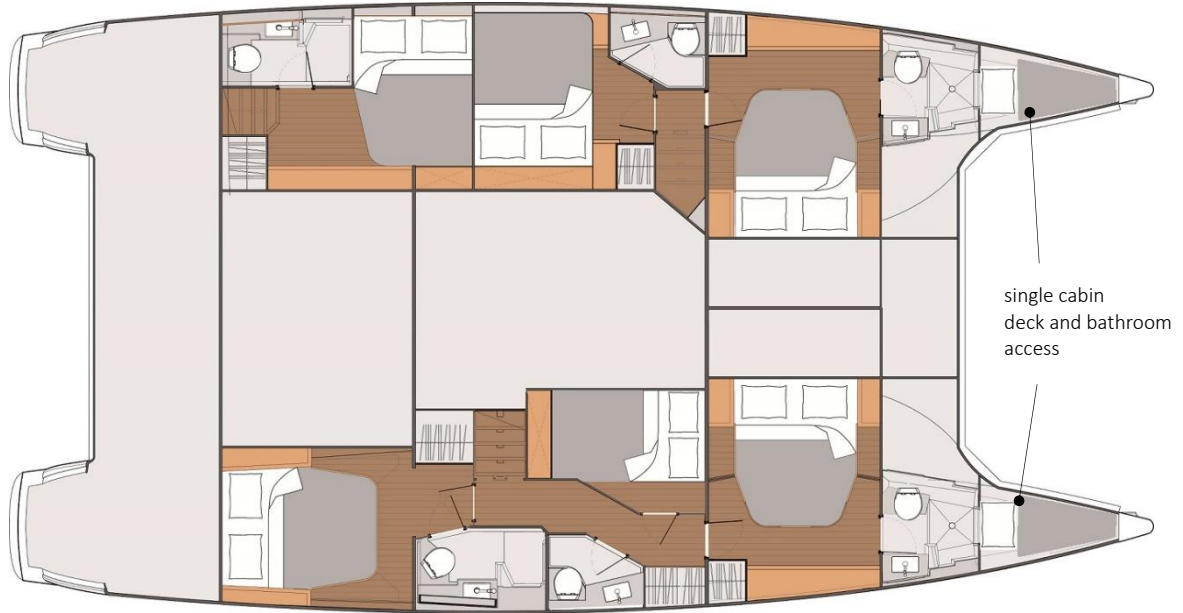

Sailing catamaran Saba 50 Grand Large

