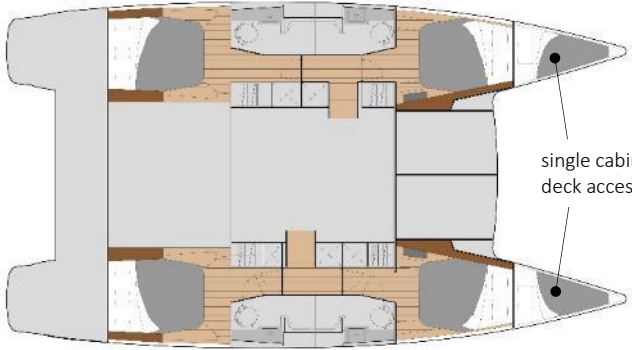

Sailing catamaran Helia 44 Evolution

BASIC INFORMATION	LAYOUT
<ul style="list-style-type: none"> ▪ Year: 2018 ▪ Builder: Fountaine Pajot ▪ Length: 13.3 m ▪ Beam: 7.4 m ▪ Draft: 1.15 m ▪ Displacement: 10,800 kg ▪ Engines: 2 x Volvo 55 HP D2 ▪ Fuel tank: 470 L ▪ Water tank: 2 x 375 L (total 750 L) ▪ Double cabins: 4 ▪ Single cabins: 2 ▪ Bed in saloon: convertible table ▪ Persons [recomm./licensed]: 8/10 ▪ Showers [cabins + deck]: 4 + 1 ▪ Heads [cabins]: 4 	 <p>single cabins deck access</p>
HIGHLIGHTS	HIGHLIGHTS - continued
<ul style="list-style-type: none"> ▪ Full air conditioning 220V 50HZ main syst. 48K BTU ▪ Watermaker 180L/h 50HZ ▪ 9KW 220V 50HZ genset ▪ 220V main system with charger 60A ▪ 2000W Inverter/charger / 220V 50hz ▪ 1500W electric windlass with circuit breaker protection ▪ Large electric marine toilet (total 4) ▪ Solar panels 4x90/100 W ▪ Electric davit winch ▪ Electric winch for mainsail ▪ Solar panels 4x90/100 W 	<ul style="list-style-type: none"> ▪ Galley fully equipped ▪ Gas barbecue ▪ Cockpit fridge ▪ Deck shower – hot & cold ▪ Teak floor transoms/cockpit ▪ Outdoor cushions ▪ PVC Dinghy 3.4m & 9.9 HP engine ▪ Fusion audio pack Bluetooth 4 Sp ▪ TV screen (22") multimedia 16/9 with DVD player units for 1 cabin ▪ 12V fans (cabins and saloon)
SALOON	GALLEY
<ul style="list-style-type: none"> ▪ Interior Layout: <ul style="list-style-type: none"> - Woodwork With Alpi - Saloon / cabin flooring : parquet - Lining on rot proof glass felt - Sofa cushions leather style - Polyeter foam mattresses ▪ Saloon: <ul style="list-style-type: none"> - Full air conditioning 220V 50HZ main syst. 48K BTU - Combination lock safe - Salon table convertible into berth - 12V fan x 2 - Saloon access through a sliding Altuglas door – 1 with entrance carpet - Panoramic view through picture windows and aft-facing porthole - Natural lighting by 2 roof bay - 1 wooden table - 6 places bench seat - Large cupboards under bench - Ventilation via 2 large front-opening hatches - Principal lighting by spot LED 	<ul style="list-style-type: none"> ▪ 12V 90L Freezer ▪ Galley fully equipped ▪ Open kitchen to the outside by sliding bay ▪ Sink work top in synthetic resin ▪ 2 stainless steel sinks ▪ Pressurized hot and cold freshwater from mixer faucet ▪ 1 draining board ▪ 1 top accessed trash can, bags removed through separate door ▪ 1 x 3 burner stove with pan holder ▪ 1 stainless gaz oven ▪ 1 cutlery drawer ▪ 190L cold storage volume (fridge) ▪ 1 large cupboard in starboard side of the entry door ▪ LED spotlighting ▪ Ventilation by 1 opening hatch above stove top
CHART TABLE	FOREPEAKS
<ul style="list-style-type: none"> ▪ Wooden chart table and storage with flap ▪ High navigation instruments console ▪ Electric panel 12V ▪ One 12V electric outlet ▪ Chart table lighting by reading light 	<ul style="list-style-type: none"> ▪ 2x Forepeak deck hatch ▪ Complete fitting out port forepeak ▪ Complete fitting out stb forepeak ▪ Access via a wooden door in for cabin ▪ Fully-painted, gel-coat finish

Sailing catamaran Helia 44 Evolution

CABINS x 4 (QUATUOR VERSION)	HEADS COMPARTMENTS x 4 (QUATUOR VERSION)
<ul style="list-style-type: none"> ▪ Curtains in cabins ▪ 12V fan (total x4) ▪ Full air conditioning 220V 50HZ main syst. 48K BTU ▪ Aft Cabin: <ul style="list-style-type: none"> - Access through wooden door in passageway - Double bed (1,60x2,00 m) with lateral access s (island bed) - 1 Drawer under bed with frontal access s - Shelving on side of bed - 1 hanging closet - 1 Console with shelves inside - Ventilation though1 deck hatch + via1 porthole overlooking rear deck - Aft and rear panoramic bay - Large non-opening outward-facing picture window - Curtains on all openings - Main lighting via spotlights LED and 2 bedside reading lights - Coat hook - Cupboards storage under bed ▪ Fore cabin: <ul style="list-style-type: none"> - Access s through wooden door in passageway - Double bed with lateral access (island bed): stb 1,60/1,3 x 2m, port 1,60/1,10 x 2m - 1 Drawer under bed with frontal access s - 1 hanging closet - 1 console with internal shelves - 1 shelve above bed - Ventilation through 1 deck hatch and 1 hull hatch - 1 escape hatch opening - Large non-opening outward-facing picture window - Curtains on all openings - Main lighting via spotlights LED and 2 bedside reading lights - Coat hook - Cupboards storage under bed ▪ Cupboards in passageways 	<ul style="list-style-type: none"> ▪ Buoyancy reserve under half-height shelf ▪ Large electric marine toilet (total 4) ▪ Access through wooden door ▪ Worktop with sink ▪ Mirror + shelves + spotlights ▪ Hot and cold water by mixer ▪ Separate shower with mixer tap with built-in showerhead ▪ Shower with electrical drainage pump ▪ Cupboard storage with internal shelves under worktop ▪ Coat hook ▪ Ventilation through 1 deck hatch
DECK LAYOUT	FIITTINGS
<ul style="list-style-type: none"> ▪ Cockpit entirely protected by a rigid bimini. Circulation without step towards the saloon. ▪ Cockpit: <ul style="list-style-type: none"> - Hard bimini top over the cockpit - Manual gangway - Exterior window blinds for salon - Gas barbecue - Cockpit fridge - Cockpit courtesy lighting - 1x 8 persons bench seat around the table - 1 Teck cockpit table - Serving hatch to the kitchen by sliding bay - 1 Fainting sofa - 1 Large storage area on the bench - 1 Large storage area on the fainting sofa - 1 Gas chest for 2 bottles 	<ul style="list-style-type: none"> ▪ G.V. and genoa: <ul style="list-style-type: none"> - 1 mainsheet tackle led aft to coach roof - 1 clutch for mainsail sheet - 1 clutch for mainsail halyard - 3 clutch for the reef - 1 Ball bearing mainsheet traveller - 2 x tackle on mainsheet traveller clutches with back on roof - 2 x genoa tracks with load block - 2 x genoa sheets - 2 x -size 50 self tailing winches for genoa and mainsail sheets - 1 size 46 self tailing winch for main sheet ▪ Other equipment: <ul style="list-style-type: none"> - Solar panels 4x90/100 W - 2 swim ladder

Sailing catamaran Helia 44 Evolution

<ul style="list-style-type: none"> - Natural lighting and ventilation via deck hatches - Lighting by waterproof spotlights ▪ Helm station: <ul style="list-style-type: none"> - Triple helmsman seat with back rest - Electric winch for mainsail - Bimini for helm station - Tent for bimini helm station - Accessed via stairs from cockpit - Instrument control panel - Bin for halyards - Stairs to access of lounge deck ▪ Lounge deck: <ul style="list-style-type: none"> - Access via stairs through helm station - Area available for solarium and mattresses. ▪ Fore deck: <ul style="list-style-type: none"> - 1 Large chest for anchorage and halyard tail storage at bottom of mast ▪ 2 Engine holds: <ul style="list-style-type: none"> - Accessed via polyester deck hatch in cockpit - Sound proofing - Neon lighting 	<ul style="list-style-type: none"> - Pulpits with 2 seating - 1 hot & cold water shower in port transom - Dralon protective cover for wheel - Teak floor transoms/cockpit - Outdoor cushions - Outdoor foredeck cushions - Both transoms protection - Chain + 25KG Anchor - PVC Dinghy 3.4m & 9.9 HP engine - Full navigational, safety and technical equipment - Leather covered steering wheel helm - 2 rudders linked mechanically by stock arm + transversal tube - Emergency tiller - 1 steering compass - 3 winch handles and 3 pockets - Pulpit and pushpit, stanchions with upper and lower guardrails - Access to transom - 2 x tender davit kayak carrier with 1 x winch 40 - 7 mooring cleats (2 foredeck + 2 middle + 2 astern + 1 in anchor well) - Mooring kit + 6 fenders - 2 x 50 ft long mooring lines - 1 x 1500W electric windlass with circuit breaker protection - Anchor fairlead under bridge deck with built-in bridle - 1 roller on forward beam - Net on forward beam - 1 kit of spare parts
<p>MOTORIZATION</p>	<p>PLUMBING</p>
<ul style="list-style-type: none"> ▪ Engines and Equipments: <ul style="list-style-type: none"> - 2 motors 55 HP (instead of 40 HP) - 2x2 blade fixed propellers - Salt water filter - Engine cooling by heat exchanger - Complete engine panel and dual controls at helm station - Hour meter ▪ Fuel system: <ul style="list-style-type: none"> - 1 Fuel tank with filling by plug-hole on bridge equipped with a anti-overflow - Electric fuel gauge (indicator on chart table) - 1 fuel pre-filter / water separator +1 engine fuel filter/engine - Fuel shutoff valves ▪ Other: <ul style="list-style-type: none"> - Triple clutche for reefs 	<ul style="list-style-type: none"> ▪ Deck shower – hot & cold ▪ Auto. switch for bilge pumps ▪ Pressurized seawater system ▪ Additional electric freshwater pump ▪ Freshwater tanks with electric gauge ▪ 1 electric pump and pressure accumulator ▪ 1 water heater 40 l ▪ 1 electrical bilge pump (2 m3/h) in each engine hold ▪ 1 electric bilge pump (2m3/h) in each hull ▪ 1 manual exterior bilge pump ▪ 1 holding tank on each W.C
<p>ELECTRICITY / ELECTRONIC</p>	<p>RIGGING & SAILS</p>
<ul style="list-style-type: none"> ▪ Power system: <ul style="list-style-type: none"> - Additional AGM battery 150A suppl. - 2 x 115A/12V engine alternators - 1 set starboard onboard/engine batteries of 600A/h - 1 port engine battery of 100A/h/ 800CCA - 1 Manual back-up link ▪ 12V electrical distribution panel: <ul style="list-style-type: none"> - Interior 12V outlet and waterproof exterior 12V outlet 	<ul style="list-style-type: none"> ▪ Mast and boom: <ul style="list-style-type: none"> - Lazy jack and lazy bag - Electric winch for mainsail - Automatic reef on the first reef - Add. windlass control chain counter - Mast and boom in anodised aluminium - Complete standing rigging - Ball bearing mainsail luff cars

Sailing catamaran Helia 44 Evolution

<ul style="list-style-type: none"> - General 12V distribution panel at chart table protected by circuit breakers - Voltmeter for onboard batteries - Spare sockets for extra equipment ▪ Other: <ul style="list-style-type: none"> - Full air conditioning 220V 50HZ main syst.48K BTU - Watermaker 180L/h 50HZ - Solar panels 4x90/100 W - 9KW 220V 50HZ genset - 1 x 1500W electric windlass with circuit breaker protection - Electric winch for mainsai - Fusion audio pack Bluetooth 4 Sp - 220V main system with charger 60A - 2000W Inverter/charger / 220V 50hz - Second VHF AIS helmstation - GARMIN Pack 2 : Autopil, VHF, AIS, 2*GPS 7410, 2*multi GMI20 - Radar + support + wiring - GARMIN autopilot remote - TV screen (22") multimedia 16/9 with DVD player units for 1 cabin - Electric head large bowl (total 4) - 12V fan (total 6) - Additional electric freshwater pump - Automatic mainsail HOOK - Automatic reef on the first reef - Add. windlass control chain counter - Electric davit winch - 1 VHF mast head antenna 	<ul style="list-style-type: none"> - 1 tackle on mainsail halyard - 1 topping lift - 3 reef pennants - 1 genoa halyard - 1 spinnaker halyard - clutches on all halyards for genoa, spinnaker and topping lift - clutches on reef pennants at boom exit - 2 flag halyards - Navigation, running and mooring lights - Deck lighting ▪ Sails: <ul style="list-style-type: none"> - Full batten CST mainsail - Genoa roller fuller - Genoa with no UV band
---	---

*Sailing catamaran
Helia 44 Evolution*

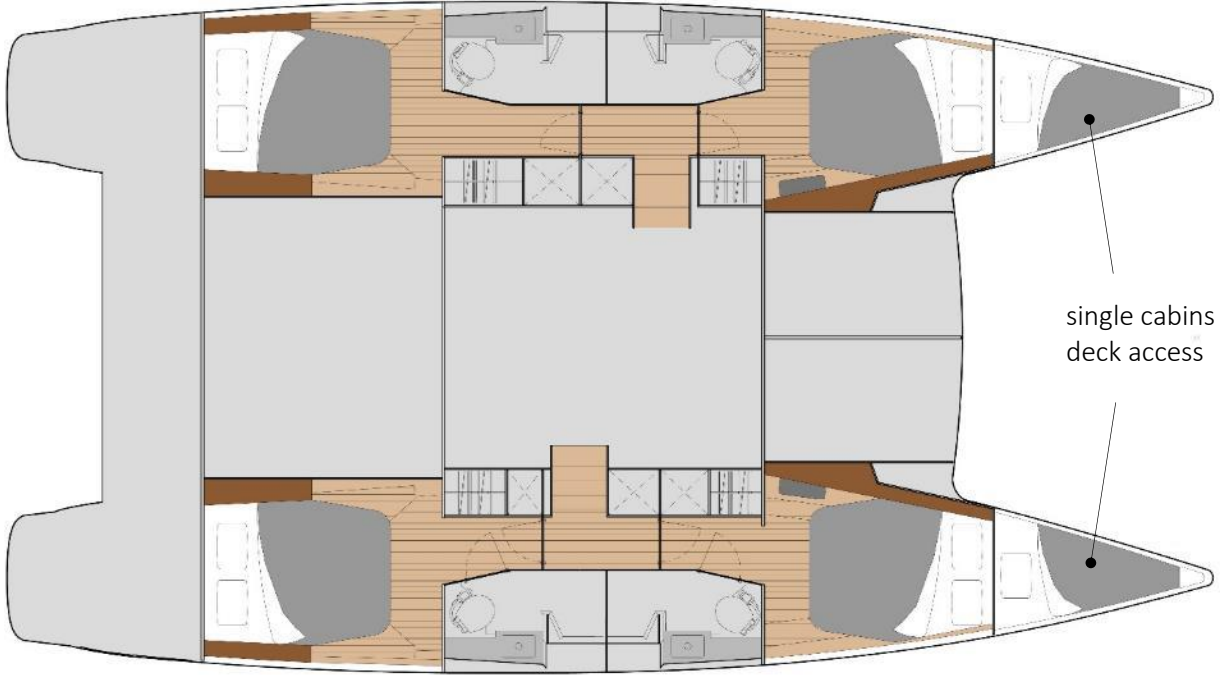

Sailing catamaran Helia 44 Evolution



* All pictures are for illustration only.